

REVISIONS					DESCRIPTION
REV.	REV. DATE	CHK. BY	CHK. DATE	ENG.	
06	08/24/05	AU	08/24/05	DR	RELOCATED FILM VIEWER

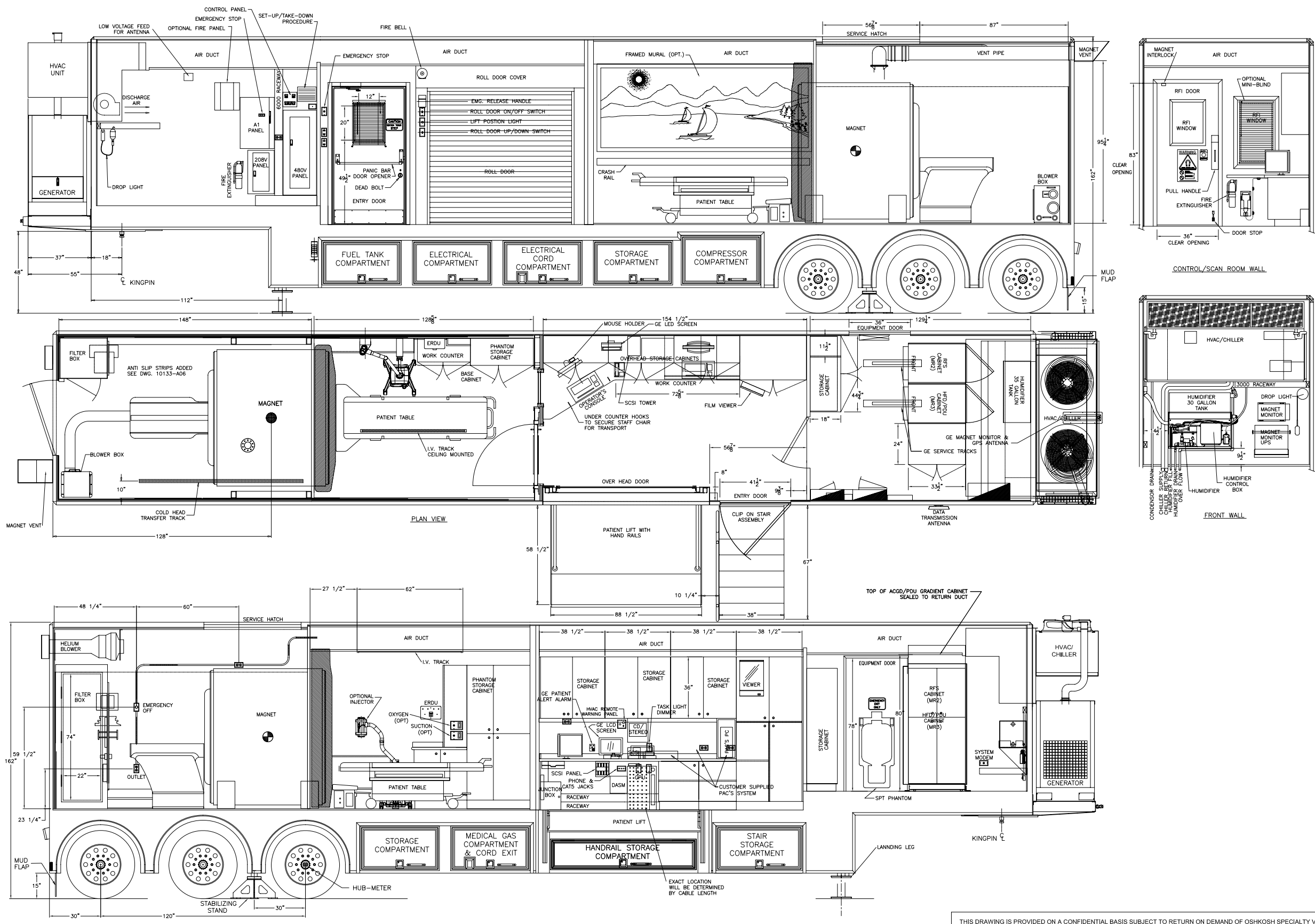

THIS DRAWING IS PROVIDED ON A CONFIDENTIAL BASIS SUBJECT TO RETURN ON DEMAND OF OSHKOSH SPECIALTY VEHICLES ("OSHKOSH"), WHICH RETAINS ANY AND ALL RIGHTS ASSOCIATED WITH IT AND THE ARTICLE OR ARTICLES IT REPRESENTS. DISCLOSURE, REPRODUCTION OR ALTERATION OF ANY PART OF THIS DRAWING OR MANUFACTURE, USE OR SALE OF THE ARTICLE OR ARTICLES REPRESENTED, IS PROHIBITED WITHOUT THE PRIOR WRITTEN AUTHORIZATION OF OSHKOSH. © OSHKOSH SPECIALTY VEHICLES (unpublished).

CUSTOMER AUTHORIZATION

COMPANY NAME: _____

NAME (PRINT): _____ TITLE: _____

SIGNATURE: _____ DATE: _____

SHEET NUMBER: 1 OF 1
JOB# _____

REFERENCE DRAWING: _____ TITLE: GENERAL LAYOUT - CANADA
GE MEDICAL SYSTEMS SIGNA 1.0/1.5T MR4
8'-6" X 13'-6" X 48'-0" TRI-AXLE TRAILER

DATE: 04/27/05
DRAWN BY: D. ROZENDAL
CHECKED BY: M. GONZALEZ
DRAWING NUMBER: 235020-A01

SCALE: 3/8"=1'-0"

OSHKOSH SPECIALTY VEHICLES
16745 S. LATHROP AVENUE
HARVEY, IL. 60426
PHONE: (708) 596-5066
FAX: (708) 596-2480